

# T FEMMINA CON MASCHIO LATERALE TS

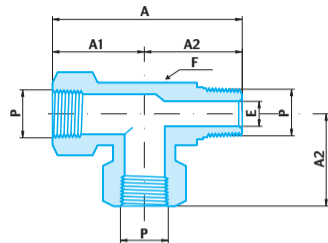

P NPT MALE & FEMALE	A	A1	A2	E	F	PART No.
1/8"	48.7	26.4	22.3	8.6	14	2 - TS
1/4"	56.4	29.7	26.7	11.4	19	4 - TS
3/8"	65.7	36.0	29.7	15.0	22	6 - TS
1/2"	76.4	39.6	36.8	18.5	27	8 - TS
3/4"	87.7	48.8	38.9	23.9	32	12 - TS
1"	93.7	48.5	45.2	29.7	41	16 - TS