



**bulk**

BULK ITALY  
Type 125

MADE IN ITALY

**GRP SUNSHADES**

INSTRUMENT SUNSHADE SERIE SS

330G SERIE SS

MODEL: 330G

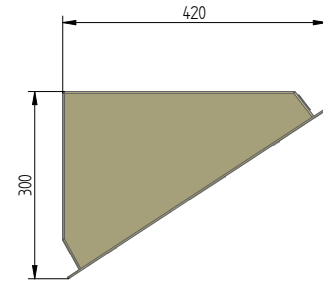
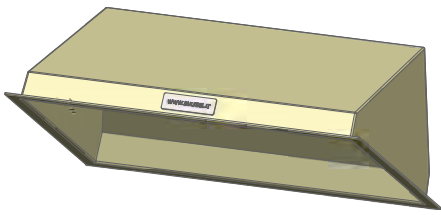

### Technical characteristics

- Instrument protection sunshade made in hot pressed GRP (Glassfibre Reinforced Polyester)
- External dimensions in mm: 680 (width) x 420 (depth) x 300 (height)
- Average thickness 3 mm
- Weight in kg: 3,5 (without accessories)
- Light grey color similar to RAL 7032
- Working temperature range: -60°C + 100°C

### Resistant to most corrosive types of environments

- UV resistant in according to EN 60079
- Positively tested Sand and Dust Procedure II - Blowing sand in according to MIL-STD-810G METHOD 510.5
- Positively tested to Salt Mist Corrosion
- Positively tested in wind tunnel up to 160 km/h

### Hardly inflammable and self-extinguishing

- "V-0" classification in according to UL 94 June 2009
- Determination of burning behavior by oxygen index in according to UNI EN ISO 4589-2: 35% Oxygen Index
- Classification of fire behavior in according to DIN 4102-1:1998: CLASS B2

### Export license

- EAC CU TR 010/2011 compliance

### Options/accessories:

- Antistatic material suitable for installation into Ex Area: see model 330N
- 2" pipe stand

# GRP SUNSHADES

## INSTRUMENT SUNSHADE SERIE SS

bulk



### HOW TO ORDER:

SUNSHADE SERIE	MATERIAL	TYPICAL ASSEMBLY	MOUNTING BRACKET MATERIAL	HOLES FOR BRACKET	PAINTING	CERTIFICATION
330	G: GRP LIGHT GREY RAL 7032	<b>SELECT FROM BELOW</b>	A: ZINC COATED STEEL	C: REQUIRED	01: NO PAINTING	F: NOT REQUIRED
			B: AISI 316	S: NOT REQUIRED	(*)	E: EAC CU TR 010/2011 COMPLIANCE
			Z: NO MOUNTING BRACKET			

(\*) Painting on demand

### EXAMPLE HOW TO ORDER: 330**G00133**BC01F

GRP SUNSHADES MODEL 330 RAL 7032 C/W 2" mounting brackets made in AISI 316 and holes, without painting nor certificate

<p>TYPICAL ASSEMBLY <b>00000</b> WITHOUT HOLES AND MOUNTING BRACKETS</p>	<p>TYPICAL ASSEMBLY <b>00133</b> SHORT SIDE ON SUPPORT 2" PIPESTAND EXTERNAL MOUNTING</p>	<p>TYPICAL ASSEMBLY <b>00233</b> SHORT SIDE ON SUPPORT 2" PIPESTAND INTERNAL MOUNTING</p>
<p>TYPICAL ASSEMBLY <b>00333</b> SHORT SIDE ON SUPPORT SINGLE BRACKET FOR 2" PIPESTAND EXTERNAL MOUNTING</p>	<p>TYPICAL ASSEMBLY <b>00433</b> SHORT SIDE ON SUPPORT DOUBLE BRACKET FOR 2" PIPESTAND EXTERNAL MOUNTING</p>	<p>TYPICAL ASSEMBLY <b>00533</b> SHORT SIDE ON SUPPORT SINGLE BRACKET FOR WALL MOUNTING</p>
<p>TYPICAL ASSEMBLY <b>00633</b> SHORT SIDE ON SUPPORT DOUBLE BRACKET FOR WALL MOUNTING</p>	<p>TYPICAL ASSEMBLY <b>00733</b> LONG SIDE ON SUPPORT 2" PIPESTAND EXTERNAL MOUNTING</p>	<p>TYPICAL ASSEMBLY <b>00833</b> LONG SIDE ON SUPPORT 2" PIPESTAND INTERNAL MOUNTING</p>
<p>TYPICAL ASSEMBLY <b>00933</b> LONG SIDE ON SUPPORT SINGLE BRACKET FOR 2" PIPESTAND EXTERNAL MOUNTING</p>	<p>TYPICAL ASSEMBLY <b>01033</b> LONG SIDE ON SUPPORT DOUBLE BRACKET FOR 2" PIPESTAND EXTERNAL MOUNTING</p>	<p>TYPICAL ASSEMBLY <b>01133</b> LONG SIDE ON SUPPORT SINGLE BRACKET FOR WALL MOUNTING</p>
<p>TYPICAL ASSEMBLY <b>01233</b> LONG SIDE ON SUPPORT DOUBLE BRACKET FOR WALL MOUNTING</p>	<p>TYPICAL ASSEMBLY <b>01333</b> SELF STANDING MOUNTING BRACKETS ON ACTUATOR</p>	

330G SERIE SS